

INNER RING CONTACT  
AREA MUST BE  $< \varnothing 52.49$

$\varnothing 86.00_{-0.05}^{-0.02}$

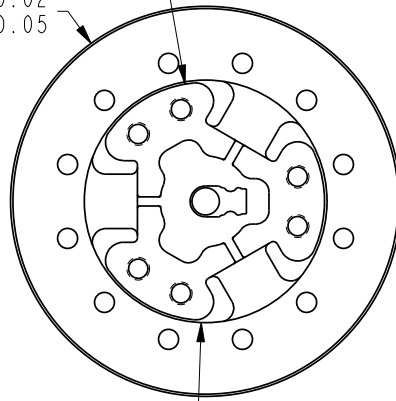

OUTER RING CONTACT  
AREA MUST BE  $> \varnothing 53.49$

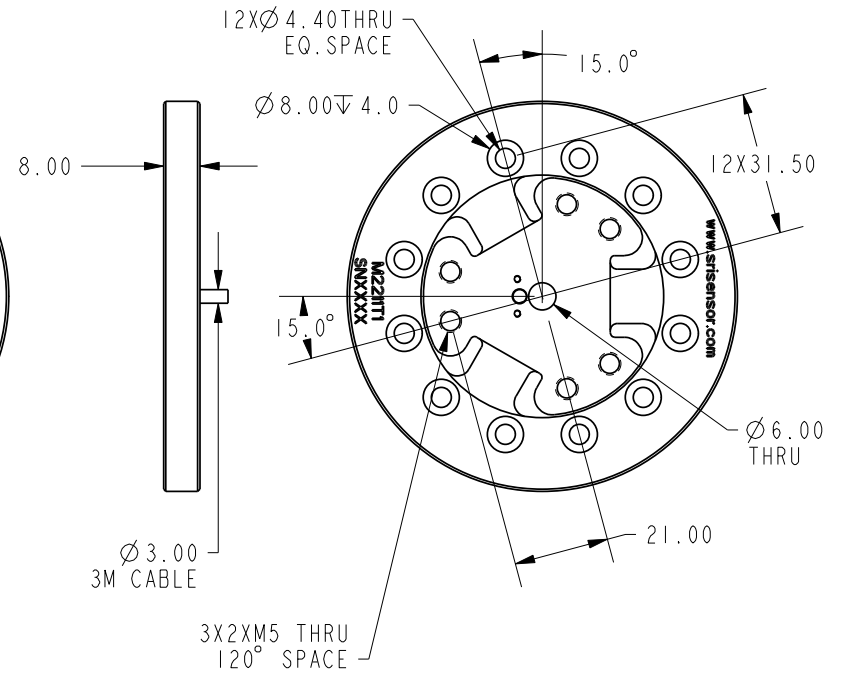

NOTE: THE OVERLOAD CAPACITIES FOR BENDING MOMENT, AXIAL AND RADIAL FORCE EXCEED 300% OF THOSE USED FOR CROSSTALK MEASUREMENT

### SPECIFICATIONS

CAPACITY (Nm)	200
OVERLOAD CAPACITY (%F.S.)	300
DIFFERENTIAL OUTPUT @ F.S. (V)	$2.5 \pm 2$
POWER SUPPLY (V)	5V
BRIDGE RESISTANCE ( $\Omega$ ) NOMINAL	1050
NON-LINEARITY (%F.S.)	0.5
HYSTERESIS (%F.S.)	1.0
OPERATING TEMP. RANGE ( $^{\circ}\text{C}$ )	-20 TO +85
CROSSTALK (%F.S.)	1.0
AXIAL FORCE FOR CROSSTALK (N)	500
RADIAL FORCE FOR CROSSTALK (N)	500
BENDING MOMENT FOR CROSSTALK (Nm)	30
TORSION ANGLE (CALCULATED)	$0.05^{\circ}$
TORSIONAL STIFFNESS (KNm/RAD)	250
BENDING STIFFNESS (kNm/RAD)	32
MASS (KG)	0.30

### WIRING CODE - BOTH CHNS

COLOR	FUNCTION
RED	+EX
GREEN	+SIG
BLACK	GND
BROWN	-SIG

**SUNRISE INSTRUMENTS**

[www.srisensor.com](http://www.srisensor.com)

TORQUE LOADCELL  
D86MM, 200 Nm

UNLESS OTHERWISE SPECIFIED  
DIMENSIONS ARE IN MM

M2211T1

REV.  
0.2